

March 2018



HydroRam

Save your time with high efficiency and performance!

Meet your needs from the most complete product line!

Worldwide sales and after sales network!

We do our best to implement our promises, responsibilities and obligations for the satisfaction of our customers.



Contact Information

RJ HAMMERS - US IMPORTER FOR HYDRO RAM TOLL FREE : 888-651-0187 OUTSIDE US : 727-215-4924
13070 92ND St.
LARGO, FL 33773
PRODUCT SUPPORT : 727-657-2916 FAX : 800-526-8317
ron@besthammers.com www.besthammers.com

Your Best Partner



Best Hammer Industries

Advanced Hydraulic Attachments history is being written by Best Hammer Industries

Best Hammer Industries was established to become a high-tech manufacturing company with advanced products and place the world-leading position in the excavator attachment industry. Best Hammer Industries manufactures hydraulic hammers and excavator attachments like quick couplers, rippers, multi processors and etc. for the overseas customers. Best Hammer Industries with the expert engineers who have worked at R&D and production departments for over 25 years, developed new products which named "PREMIUM SERIES HYDRAULIC HAMMERS" - under its own technology

R&D investment for advancing to No.1 technology for Best Hammer Industries' customers.

Best Hammer Industries invests in R&D for manufacturing the No.1 hydraulic hammers. Best Hammer Industries always open its ears to listen to the customers to meet their preferences as we put our top priority on the customers satisfaction.

Best Hammer Industries is certified according to ISO9001:2008, ISO14001:2004. CE

Goals

Best Hammer Industries is fully committed to growing up to the global top player in the field of hydraulic hammers by supplying the best quality of products and services to the customers.

Best Hammer Industries will always be with the customers for the creation of their advanced value.

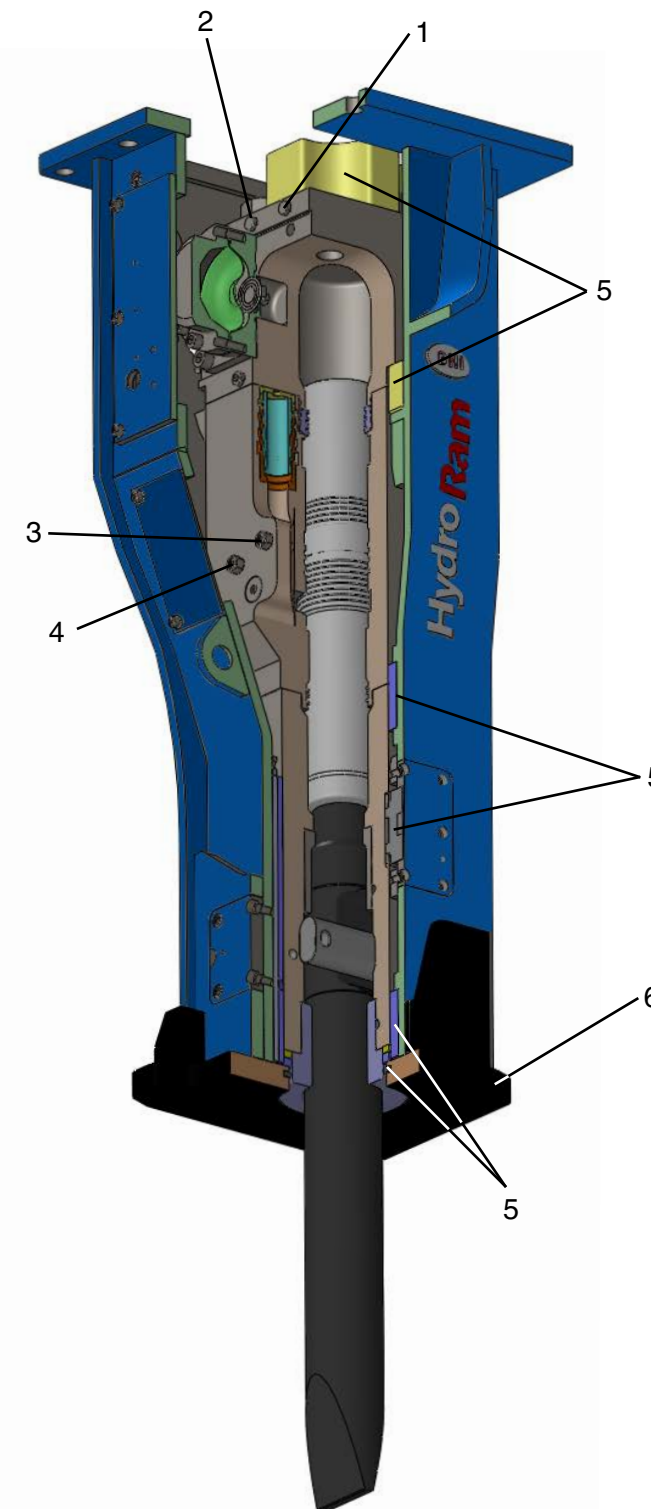

HydroRam HYDRAULIC HAMMERS

Optimum Performance

Advanced hydraulic system design technology makes maximum output energy and efficiency. The high-quality materials for long service life. Long piston and stroke for optimum impact power into the rock.

Operator-friendly

Best Hammer Industries' Hammers are ready for special applications.

1. Underwater port for optional underwater operation.
2. Auto-Lube and grease channel provide grease to bushings automatically to ensure proper lubrications and it gives longer service life to bushings and tools.
3. Stroke and blow speed can be controlled by cylinder adjuster in accordance with the operator's needs.
4. Anti blank firing system is installed as standard on the Premium series for eliminating damaging blank or dry firing.
5. Power cell is enclosed fully inside the box housing by pads and side dampers.
6. Highly wear-resistant materials also increase the hammer durability. It reduces the noise and strain on operator and machine. It makes operator comfortable and work efficiency improved.



Watch Video
Scan the QR code or
visit our website
www.bhice.com

HydroRam

PREMIUM SERIES HAMMERS



HK230S



HK300S



HK580S

PREMIUM SERIES HAMMERS

Model		HK230S	HK300S	HK580S
Recommended Carrier	tons	20-28	28-35	40-65
	US tons	22-30.8	30.8-38.5	44-71.5
Impact Energy Class	ft lbs	6,000	10,000	14,000
Impact frequency	bpm	370-750	L:200-350	L:160-250
			H:260-420	H:250-350
Working Weight	kg	1,950	3,000	4,450
	lbs	4,290	6,600	9,790
Oil Flow	lpm	120-180	180-260	240-320
	gpm	31.7-47.6	47.6-68.7	63.4-84.5
Operating Pressure	bar	160-180	160-180	160-180
	psi	2,320-2,610	2,320-2,610	2,320-2,610
Tool Diameter	mm	138	155	180
	inch	5.43	6.1	7.09

1. "Impact Energy Class" does not relate to measured impact energy. It is a marketing rating.
2. Working weights may vary depending on the bracket configuration.
3. Specifications are subject to change without notice.
4. For more information on Hydraulic hammers, please contact BHI authorized dealer or visit our website at : www.bhice.com

PREMIUM SERIES HAMMERS

BHI Best Hammer Industries

SMALL HAMMERS

MEDIUM HAMMERS

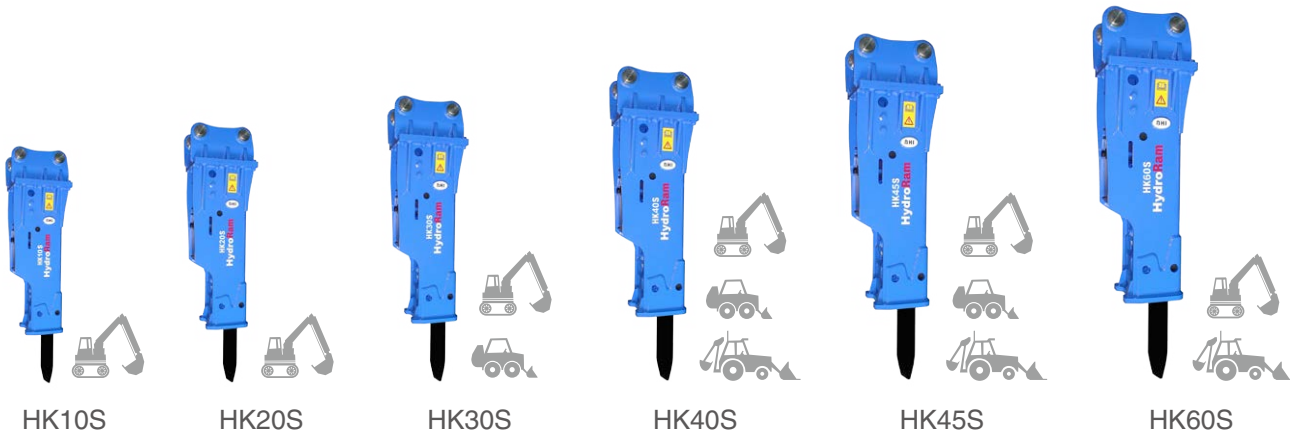

SMALL HAMMERS

Model		HK10	HK20	HK30	HK40	HK45	HK60
Recommended Carrier	tons	1.0-2.5	1.7-3.2	2.5-3.8	2.8-4.5	3.5-6	06-13
	US tons	1.1-2.8	1.9-3.5	2.8-4.2	3.1-5	3.9-6.6	6.6-14.3
Impact Energy Class	ft lbs	250	350	500	750	1,000	1,500
Impact frequency	bpm	700-1,200	600-1,200	600-1200	440-1,200	400-1,200	440-850
Working Weight	TB Type	kg	120	140	185	300	525
		lbs	264	308	407	660	1,155
	BH Type	kg	125	155	195	300	540
		lbs	275	340	430	660	1,190
OilFlow	lpm	20-40	25-45	30-45	30-50	40-70	45-80
	gpm	5.3-10.6	6.6-13.2	08-12	08-13	10.6-18.5	12-21.1
Operating Pressure	bar	90-120	90-120	100-130	100-130	100-130	130-150
	psi	1,305-1,740	1,305-1,740	1,450-1,885	1,450-1,885	1,450-1,885	1,885-2,175
Tool Diameter	mm	45	53	58	68	75	90
	inch	1.77	2.08	2.28	2.67	2.95	3.54

MEDIUM HAMMERS

Model		HK80	HK130	HK200	HK210	HK220
Recommended Carrier	tons	10-16	12-20	18-25	18-26	20-28
	US tons	11-18	13.2-22	19.8-27.5	19.8-28.6	22-30.8
Impact Energy Class	ft lbs	2,500	4,000	4,800	4,800	5,000
Impact frequency	bpm	450-750	410-700	360-600	400-800	370-460
Working Weight	TB Type	kg	870	1,260	1,780	1,800
		lbs	1,910	2,770	3,920	3,960
	BH Type	kg	890	1,300	1,850	1,900
		lbs	1,960	2,860	4,070	4,180
OilFlow	lpm	80-110	110-150	100-135	125-150	120-180
	gpm	21.1-29.1	29.1-39.6	26.4-35.7	33-39.6	31.7-47.6
Operating Pressure	bar	150-170	150-170	150-180	160-180	160-180
	psi	2,175-2,465	2,175-2,465	2,175-2,610	2,320-2,610	2,320-2,610
Tool Diameter	mm	100	120	135	135	138
	inch	3.94	4.72	5.31	5.31	5.43

BRACKET CONFIGURATION

- 1. "Impact Energy Class" does not relate to measured impact energy. It is a marketing rating.
- 2. Working weights may vary depending on the bracket configuration.
- 3. Specifications are subject to change without notice.
- 4. For more information on Hydraulic hammers, please contact BHI authorized dealer or visit our website at : www.bhice.com

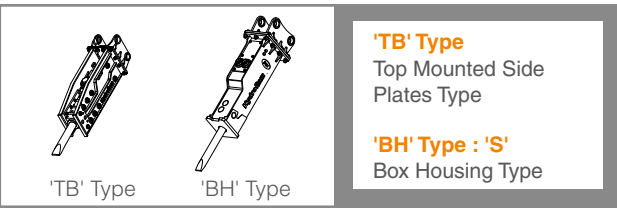

BRACKET CONFIGURATION

- 1. "Impact Energy Class" does not relate to measured impact energy. It is a marketing rating.
- 2. Working weights may vary depending on the bracket configuration.
- 3. Specifications are subject to change without notice.
- 4. For more information on Hydraulic hammers, please contact BHI authorized dealer or visit our website at : www.bhice.com

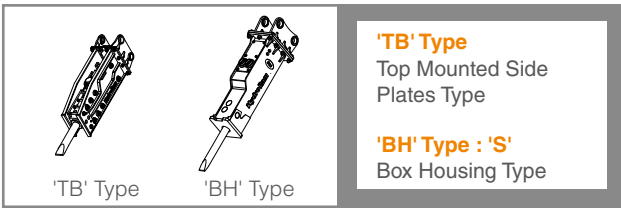

LARGE HAMMERS

Working Tools



LARGE HAMMERS

Model		HK250	HK280	HK330	HK380	HK500
Recommended Carrier	tons	22-30	28-35	29-36	34-45	40-65
	US tons	24.2-33	30.8-38.5	31.9-39.6	37.4-49.5	44-71.5
Impact Energy Class	ft lbs	7,500	9,000	10,000	12,000	13,000
Impact frequency	bpm	300-450	320-400	250-400	220-380	250-350
Working Weight	TB Type	kg	2,310	2,710	3,010	3,780
		lbs	5,080	5,960	6,620	8,320
	BH Type	kg	2350	2,780	3,025	3,865
		lbs	5,170	6,120	6,645	8,500
OilFlow	lpm	140-190	170-240	180-250	210-290	240-320
	gpm	37-50.2	44.9-63.4	47.6-66	55.5-76.6	63.4-84.5
Operating Pressure	bar	160-180	160-180	160-180	160-180	160-180
	psi	2,320-2,610	2,320-2,610	2,320-2,610	2,320-2,610	2,320-2,610
Tool Diameter	mm	145	155	158	170	180
	inch	5.7	6.1	6.22	6.69	7.09

- 1. "Impact Energy Class" does not relate to measured impact energy. It is a marketing rating.
- 2. Working weights may vary depending on the bracket configuration.
- 3. Specifications are subject to change without notice.
- 4. For more information on Hydraulic hammers, please contact BHI authorized dealer or visit our website at : www.bhice.com

BRACKET CONFIGURATION

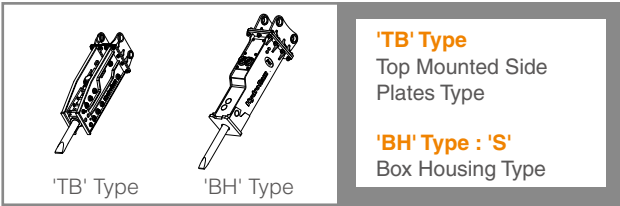

Optimum performance by Genuine Parts and Working Tools.

High durability is ensured by Best Hammer Industries' genuine parts and working tools which the finest raw materials and heat treatment process are utilized.

The appropriate working tools are inseparable to get the maximum performance of hydraulic hammers.

Advanced heat treatment process and design provide longer service life and enhanced value. Best Hammer Industries offers a variety of working tool configurations for a given application. Our tool options are in below.

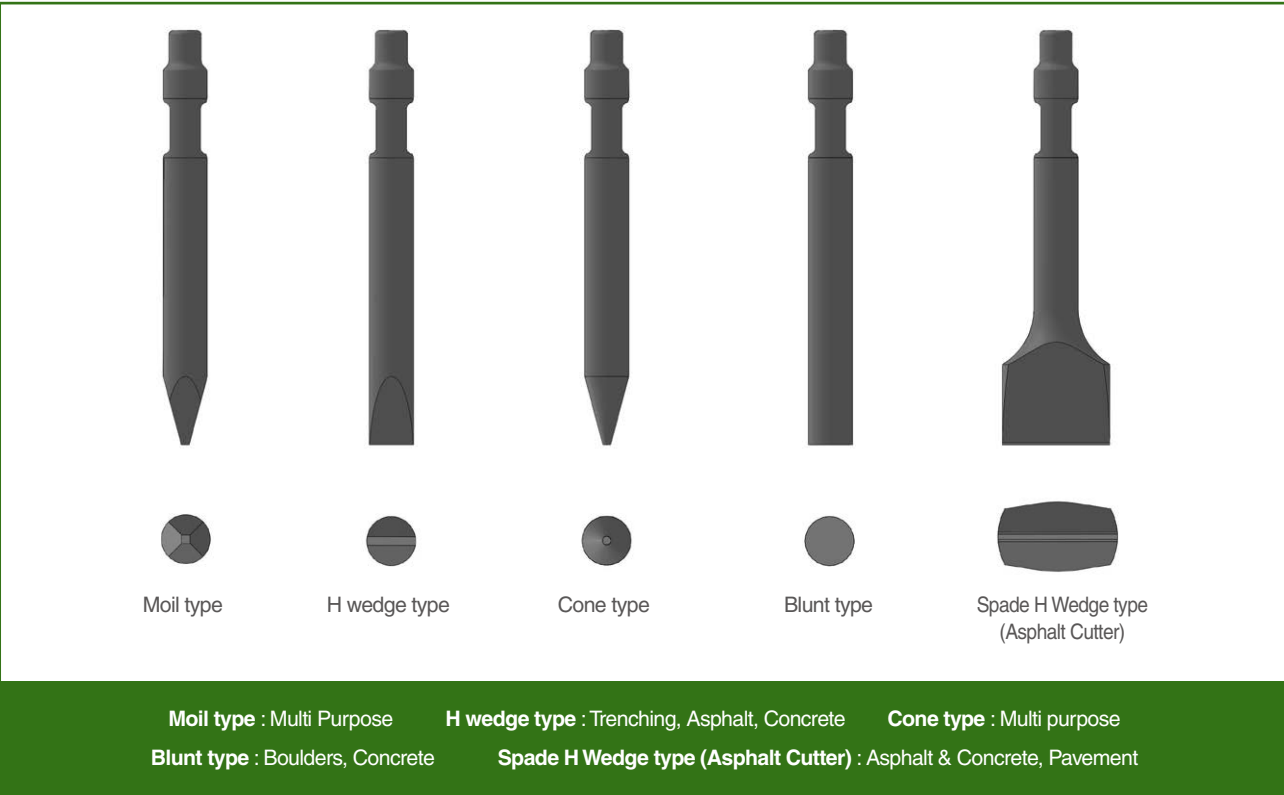

Other special designs and different lengths are available on request.

For more information, please contact your local authorized Best Hammer Industries dealer.



E-CATALOGUE : Scan the QR code to get specification in your mobile.

Excavator Attachments

BHI Multi-Processors

Best Hammer Industries' Multi-Processors are engineered for demolition, road and bridge construction and recycling operations. Jaws are interchangeable and we offer crusher, pulverizer, shear and demolition jaws.

	Model	Weight(kg/lbs)	Applicable Carrier(ton/ lbs)
Multi-Processors	2	1,760 - 3,310 / 3,870 - 7,280	18 - 48 / 39,600 - 105,600

BHI Pulverizers

Best Hammer Industries' Pulverizers are ideally designed for using in a wide range of secondary demolition and recycling duties. BHI pulverizers will reduce your investment and operation costs.

	Model	Weight (kg / lbs)	Applicable Carrier (ton / lbs)
Pulverizers	7	1,250 - 3,450 / 2,750 - 7,590	18 - 48 / 39,600 - 105,600

BHI Crushers

Best Hammer Industries' Crushers are designed for concrete demolition in inhabited areas. And also crushers are engineered as making little noise. It is used in pulverizing concretes and cutting reinforcement iron.

	Model	Weight (kg / lbs)	Applicable Carrier (ton / lbs)
Crushers	2	1,760 - 3,310 / 3,870 - 7,280	18 - 48 / 39,600 - 105,600

BHI Shears

Best Hammer Industries' Shears are engineered for versatile job applications. Best Hammer Industries Shears are designed to maximize performance, longevity and safety with significantly reduced maintenance time. Shears are used in demolition for cutting H beam, Pipe and etc.,

	Model	Weight (kg / lbs)	Applicable Carrier (ton / lbs)
Shears	3	2,000-2,950 / 4,400 - 6,490	18 - 48 / 39,600 - 105,600

BHI Grapples

Best Hammer Industries' Grapples are designed for various applications, such as demolition, waste, logging and material handling. We have 5 series of grapples with 43 different models - Mechanical grapple, Orange grapple , Scrap grapple, Stone grapple and Wood grapple. You can choose the best models according to your job applications in BHI Grapples.

	Series	Models	Weight (kg / lbs)	Applicable Carrier (ton / lbs)
Grapples	5	43	150 - 3,110 / 330 - 6,850	1 - 50 / 2,200 - 110,000

BHI Quick Couplers

Best Hammer Industries' Quick Couplers are ideal for increasing productivity and efficiency, and enhancing performance. Best Hammer Industries' Quick Coupler will transform your hydraulic excavator from a machine that simply digs, to a multi tool carrier capable of carrying out numerous tasks on job sites and all at the flick of a switch from the comfort and safety of the cab.

	Model	Weight (kg / lbs)	Applicable Carrier (ton / lbs)
Quick Couplers	7	35 - 989 / 77 - 2,180	2.8 - 90 / 6,160 - 198,000

BHI Rippers

Best Hammer Industries' Rippers are specifically designed for quarry applications as an alternative to blasting and the job-sites where the hydraulic hammers cannot work. It is designed for quiet.

	Model	Weight (kg / lbs)	Applicable Carrier (ton / lbs)
Rippers	8	50 - 782 / 110 - 1720	2.5 - 90 / 5,500 - 198,000

For more information on Best Hammer Industries' excavator attachments, please e-mail at : sales@bhice.com or visit our website at : www.bhice.com